



## ELECTRICIAN'S INSTRUCTIONS FOR MODEL NG110 (120 VAC)

### INSTALLATION

This power base is designed to control electric floor-warming systems. The resistive load must not exceed 1800 watts (NI) @ 120 VAC (15 A). The thermostat is equipped with a Ground Fault Circuit Interrupter (GFCI) and therefore the isolation of the line and load are required for operation. **Do not cap all the white wires together.** During a ground fault, both line and load will be cut-off. Connect thermostat as shown on diagram.

Must be installed in accordance with national and local electrical codes.

**TURN OFF POWER TO THE HEATING SYSTEM AT THE MAIN POWER PANEL TO AVOID ELECTRICAL SHOCK.**

#### 1 Connecting wires and mounting power base

- Connect the power base wires to the supply and load using solderless connectors for copper wires. See diagram.
- Push the excess wire back into the electrical box to prevent interference with the power base.

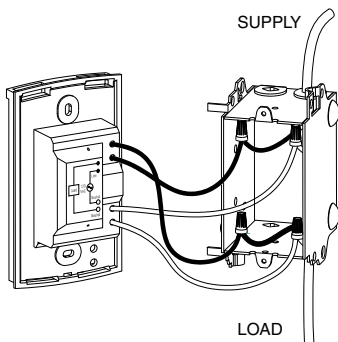

**NOTE:** All cables and connections must conform to the local electrical code.

**WARNING:** Special CO/ALR solderless connectors must be used when connecting with aluminum conductors.

#### 2 Connecting temperature sensor wire

- The wire must pass outside the electrical box and follow the wall down to the floor. The sensing probe should be placed in a representative heat area for maximum system performance.
- The sensing probe should be centered between the wires in the mat. The temperature sensor wire cannot cross any heater wires and the sensing probe must NOT be directly on or adjacent to a heating wire.
- Secure the power base with the screw.
- Connect the temperature sensor wire to terminals 3 and 4 on the power base (no polarity needs to be respected).
- Once the power base is properly installed, mount the faceplate.

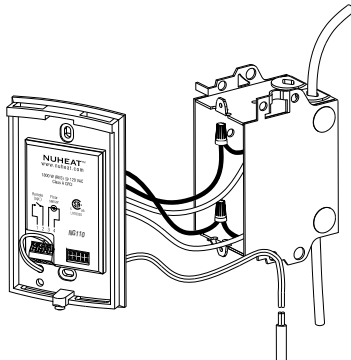

### MOUNTING THE FACEPLATE

Keep the thermostat's air vents clean and free from obstructions.

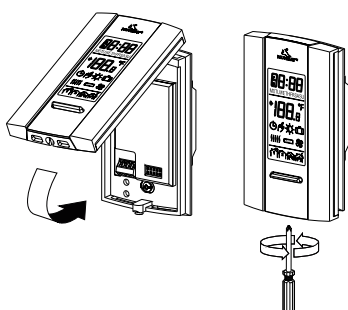

- 1 Locate the screw at the bottom of the front module.
- 2 Secure the thermostat with the screw.
- 3 Turn the power back on.

### POWER ON

When the unit is power on for the first time, the following appears on-screen:

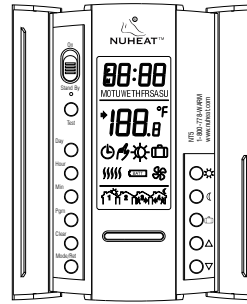

Time (0:00)  
Floor temperature  
Manual mode icon ( )

If improperly installed, you will see the LO or HI error message.

**LO:** Floor temperature is below 0°C (32°F); or temperature probe is defective (open) or not connected.

\*If the heating indicator is also displayed, then the relay is closed and current is going through the load.

**HI:** Floor temperature is above 60°C (140°F); or temperature probe is shorted.

### GFCI TEST

- 1 Adjust the setpoint temperature until the heating indicator ( ) appears on-screen.
- 2 Press TEST. The test is successful if the GFCI warning light is ON and power is cut-off. The heating indicator ( ) should still appear.
- 3 Switch power to Standby, then reset to ON.

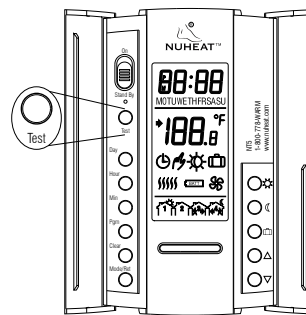

If test fails:

- A- Verify installation.
- B- Check the load wires.
- C- Verify that the thermostat is in heating mode with Heating indicator ON.

Once you've identified the problem, run the GFCI test again.

### TECHNICAL SPECIFICATIONS

Model:	NG110
Supply:	120 VAC, 50/60 Hz
Load:	15 A maximum
Power:	1800 watts (NI) @ 120 VAC
Ground Fault Circuit Interrupter (GFCI):	Class A (5 mA)
Approvals:	CSA / C,US
Storage:	-4°F to 120°F (-20°C to 50°C)

### WARRANTY

#### NUHEAT INDUSTRIES ONE (1) YEAR LIMITED WARRANTY

This product is guaranteed against workmanship defects for a one-year period following the initial date of purchase. During this period, NUHEAT will repair or replace, at our option and without charge, any defective product which has been used under normal conditions.

The warranty does not cover delivery costs and does not apply to products poorly installed or randomly damaged following installation.

This warranty cancels and replaces any other manufacturer's express or implied warranty as well as any other company commitment. NUHEAT cannot be held liable for related or random damages following the installation of this product.

The defective product as well as the purchase invoice must be returned to the place of purchase or mailed, prepaid and insured, to the following address:

#### NUHEAT INDUSTRIES LTD.

USA  
880 Grant Avenue  
Blaine, WA  
98230

CANADA  
1689 Cliveden Avenue  
Delta, BC  
V3M 6V5

1 (800) 778-9276  
www.nuheat.com

NUHEAT™ is a registered trademark of Nuheat Industries LTD.